



# Brindlestone Close

Hunsbury Meadows, Northampton



GROUND FLOOR

1ST FLOOR

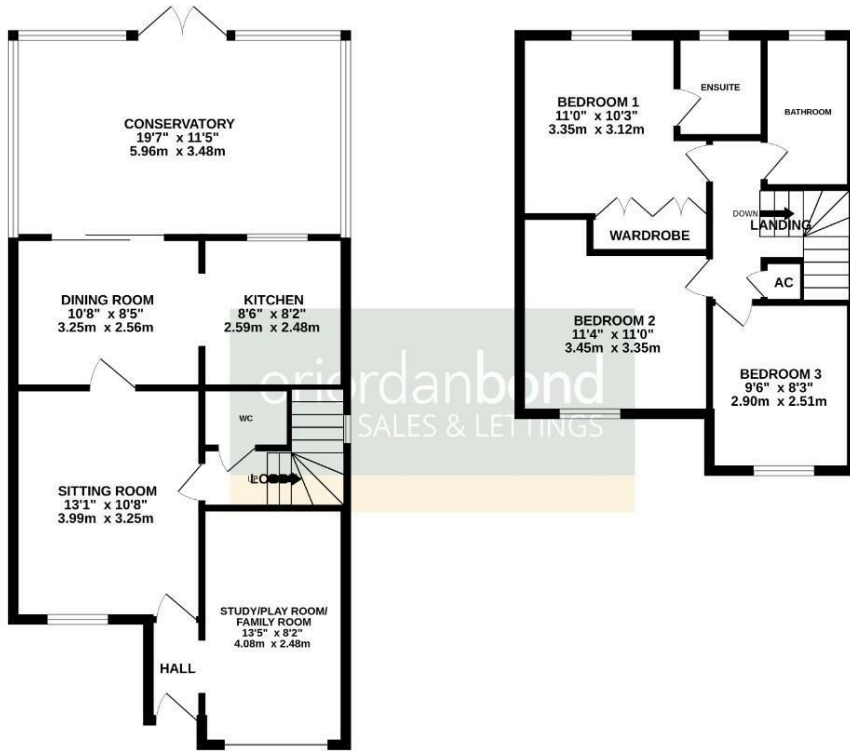

TOTAL FLOOR AREA: 1123 sq ft. (104.3 sq m.) approx.  
Whilst every effort has been made to ensure the accuracy of the floorplan contained here, measurements of doors, windows, rooms and any other items are approximate and no responsibility is taken for any error, omission or mis-statement. This plan is for illustrative purposes only and should be used as such for any prospective purchaser. The services, systems and appliances shown have not been tested and no guarantee as to their operability or efficiency can be given.  
Made with Metropix (15/02/16)

## Brindlestone Close

Hunsbury Meadows  
NN4 9QQ

A well presented three bedroom detached house in the popular area of Hunsbury Meadows offering accommodation over two floors.

Entrance hall with access to a study/play room with integrated appliances and a large insulated roof. There is also an inner cloakroom/WC. To the first floor is accommodation fitted combination boiler, doors to three bedrooms and a separate family bathroom. Corner plot with block paved driveway front offering a lawn with planted borders, and fencing to enclose. Further benefits include (B/1123/L)

### Additional information

- Council Tax Band: C
- Energy Efficiency Rating: C

### Viewing

Viewing strictly by appointment – details only

### Disclaimer

O'Riordan Bond Estate Agents Limited provides services and so cannot verify they are correct or verification from their solicitor or surveyor.

O'Riordan Bond Hunsbury Sales  
01604 706007

[hunsbury@oriordanbond.co.uk](mailto:hunsbury@oriordanbond.co.uk)